

DRAWN ARC WELDER PS-DA5

Precise Aluminum Dent Repair

The Pro Spot PS-DA5 Drawn Arc Welder is the latest technology in precise dent pulling for aluminum repair. Using drawn arc technology, the PS-DA5 easily applies pulling keys and threaded studs so that various tools can be used to pull dents from aluminum panels that would otherwise need replacing.

Pro Spot has a large variety of pullers and tools available for the PS-DA5 for various aluminum repair applications.

These applications are key for aluminum repairs as more and more aluminum vehicles hit the market. This is a must have aluminum repair tool when working on the new mixed matrix vehicles.

The Pro Spot PS-DA5 has a wide range of configurations to best fit your shop's needs. The PS-DA5 can be added to a weld cart, or even a Mobile Weld Station for additional storage and mobility.



Technical Specifications

Input Power:	Three Phase 208-240V 50/60Hz @ 40A
Current Range:	250/300/400/500 A
Protection Degree:	IP 21
Dimensions:	28x18x18
Weight:	95lbs. (43kg)

PRECISE ALUMINUM REPAIR USING DRAWN ARC TECHNOLOGY

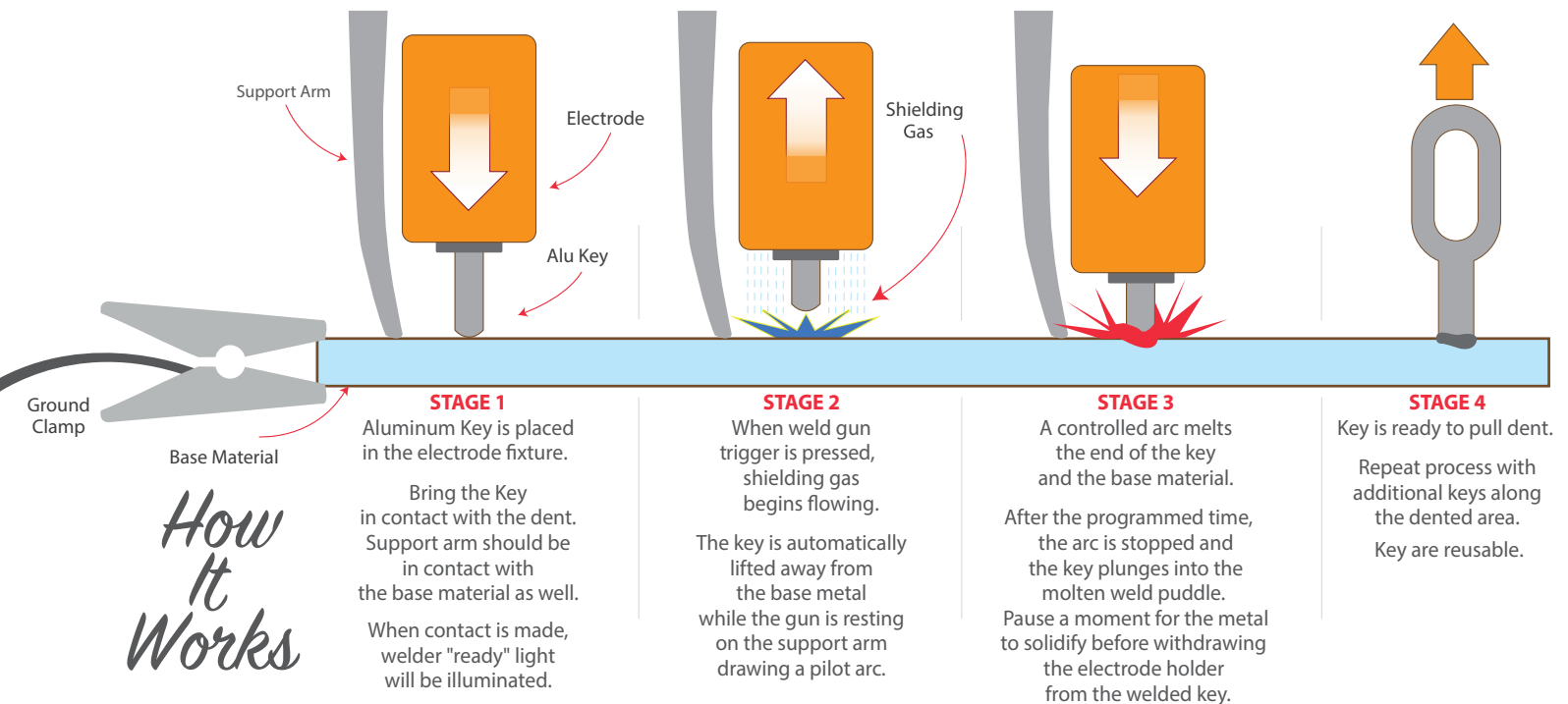

760-407-1414

info@prospot.com

www.prospot.com

Pro Spot International, Inc. U.S.A. 5932 Sea Otter Place Carlsbad, CA 92010

Toll free (US only): 877 PRO-SPOT (776-7768)