

THE PROFESSIONAL DENT REPAIR SOLUTION

GPR – GLUE PULL REPAIR

Introducing the updated Dent Repair Station with a revolutionary glue tab solution. Say goodbye to time-consuming welding or arc procedures, as the Pro Spot Glue Tab Dent Repair Kit revolutionizes the dent repair process, significantly reducing repair time.

Designed to work seamlessly on both Aluminum and Steel surfaces, including painted materials, this kit eliminates the need for grinding. With its wide array of pull accessories and reusable pull tabs, it caters to various dent types, ensuring versatility and convenience. Best of all, there's no need for panel removal, effectively eliminating the risks of backside corrosion, burn through, and welding. Experience a faster, more efficient dent repair process with the Pro Spot Glue Tab Dent Repair Kit. Streamline your workflow and achieve outstanding results without compromising on quality or safety.

ACCESSORIES - ACCESSIBLE AND READY TO GO

Professional dent pulling equipment and accessories are included with the station, so anything you need to get the job done, and get it done right, are right there at your fingertips.

- Convenient holders for Glue and Heat Guns, Glue Sticks, Infrared Thermometer, and alcohol bottles.
- Vertical Toolboard provides easy access to equipment on front and back.
- Includes our patented Pro Pull Dent Puller that can be used for pulls with Glue, Aluminum projects.
- An assortment of pull and lever bars are also stored on the cart, as well as both steel and aluminum hammers.
- Lockable drawers for security purposes.
- Extended workspace with built-in work surface and fold-out table

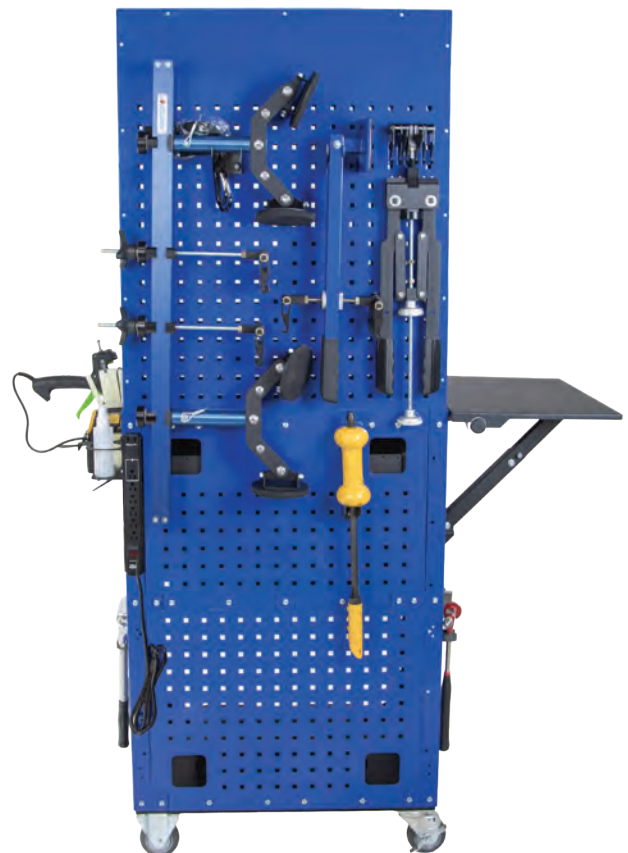



PRO-GTK GLUE TAB DENT REPAIR KIT

The Pro Spot Glue Tab Dent Repair Kit will help with your dent repair process by cutting repair time by avoiding welding or arc procedures.

This kit works on Aluminum and Steel, directly on painted materials. No need to grind. It has multiple style pull accessories for any dent and Reusable Pull Tabs. No panel removal is required and it eliminates any backside corrosion, burn through and welding.

All the Glue Tabs you need are neatly stored in two lockable drawers for quick and easy access. Each drawer features pre-printed labels identifying the tab types and includes QR codes for use instructions and reordering.

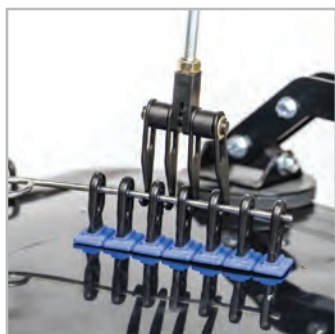

Pull dents without welding.



Quickly remove dents when paired with the PB-10 Pull Bar.



Easily remove plastic tabs after pulling is complete.



Plastic tabs are reusable and ready to pull dent after dent.

APPLIES IN 4 EASY STEPS



1 Plug in the glue gun and let it heat up while you prepare the dent and materials.



2 With 91% alcohol, clean the area you plan on repairing.

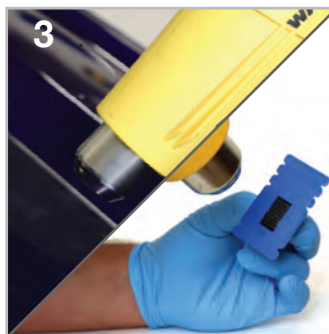

3 Heat up the panel and the tab to remove remaining moisture or contaminants from the panel and the plastic pull tab.



4 Apply glue to the pull tab and set it on the dent in the area you wish to pull.

