

## INNOVATIVE TOOL FOR FAST AND ACCURATE DENT PULLING

The Pro Pull is designed to be extremely flexible with interchangeable blocking plates and the adjustable weld shaft. The patented Pro Pull has many options to maximize the dent pulling technique.

### KEY FEATURES

- No weld cable required between tool & weld handle
- Makes dent repair quick, easy & accurate
- 3 different blocking plates
- Fast changing blocking plate system
- Adjustable weld shaft
- Available for any weld gun

Dimensions (Tool):	8.5" x 1.5" x 8.25" 21.6cm x 3.8cm x 21cm
Dimensions (Carrying Case):	14" x 3.25" x 10.25" 35.6cm x 8.26cm x 26cm
Weight (Tool Only):	2.5lb (1.13kg)
Weight (With Case):	3.5lb (1.59kg)
Blocking Plate System:	0.75" (1.9cm) dia. 2.5" (6.35cm) x 1.5" (3.8cm) 1.75" x 1"
Weld Shaft Diameter:	5/8"

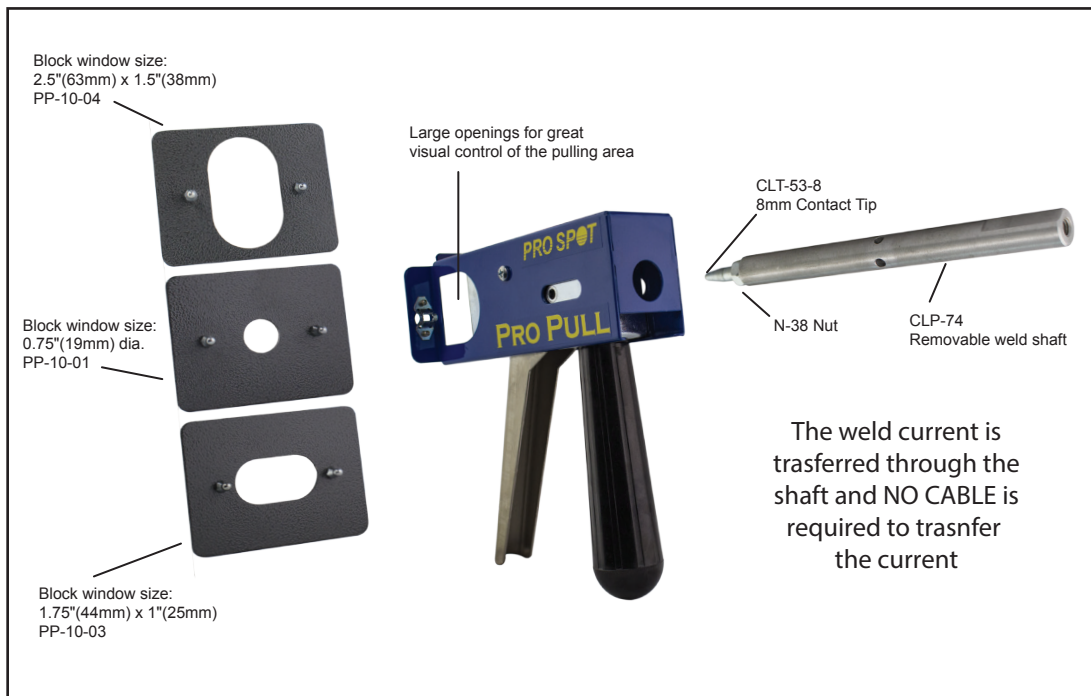

### Start Pulling Dents 3 Easy Steps!

- 1 Aim, position and fire!



- 2 Pull Dent with Auto blocking



- 3 Twist gun to release

